



Muziekcentrum De Bosuil

Vrakkerveld 2c
6002 AZ Weert

Mail: info@debosuil.nl

Web: www.debosuil.nl

Tel: +31 (0)495 52 42 69

TECHNICAL RIDER

UPDATE 28-08-2011

BUILDING

Capacity: 600 people

Parking: Loading dock behind the stage accessible for tour busses and trailers.
Power outlets for tour busses on the outside of the building
Free parking around the building.

Backstage: 2 backstage area's with own sofa, shower, toilet and fridge. Direct access to the stage.

STAGE

Dimensions: 8 x 6 x 0,75 meter (clearance 4,5 meter)

Power: Sound 1 x 32A CEE 5-pin
Light 1 x 63A, 1 x 32A CEE 5-pin
Extra 1 x 32A CEE 5-pin

Risers: 6 x Nivoflex Stabilo riser (2 x 1 x 0,2/1 meter)

Backdrop: 6 meter truss with electric hoists

SOUND

- PA: 12 x KS C LINE 2 x 8"/1" High Definition Line Array system
4 x KS C WL 18" Long Excursion Subwoofer
2 x KS T SUB 8 x 10" Triple chamber Sub Extender
3 x KS CA 4D 2 x 700 + 350Wrms System Amplifier with FIRTEC DSP
2 x KS TA 2D 2 x 2kW Amplifier with integrated FIRTEC DSP module
- Controls: Digico SD 8 mixing console 48 channels
Tascam CD recorder CD-RW901SL
- Monitor System: 6 x KS T4 M 12"/2" 2-way Extreme Performance Monitor
1 x KS CB 18 18" Subwoofer + KS T4 M 12"/2" Monitor (drumfill)
3 x KS CA 4D 2 x 700 + 350Wrms System Amplifier with FIRTEC DSP
All monitors are bi amp
- Controls: Yamaha M7cl Digital mixing console 48 channels (7 monitor groups)
- Microphones: 8 x Sennheiser E904 toms
4 x Sennheiser E906 guitar
2 x Sennheiser E604 snare bottom
2 x Shure Beta 56a snare top
2 x Shure Beta57a instrument
2 x Shure SM57LCE vocals
2 x Sennheiser MD421-II-4 instrument
5 x Shure Beta58a vocals
2 x Electro Voice RE320 all-purpose
1 x Neumann KM184 MT (matched pair)
4 x AKG C391B OH/multipurpose
1 x SE Electronics stereo set (matched pair)
8 x BSS AR 133 Active DI-BOX
2 x Cordial CES 1 passive DI box

For questions about sound contact: Geer van Tuel

Tel: +31 (0)495 54 42 13

Mail: marjageer@zonnet.nl

LIGHT

Lighting Desk: Avolites Pearl Tiger

Dimmers: 3 x SGM 810D 8 channel dimmer
2 x Lite Puter 4 channel dimmer

Lights: 40 x PAR 64 500W Raylight
16 x PAR 64 ACL
6 x PAR 64 floorspot
6 x Profile spot 1,2 KW
4 x Fresnel spot 500W
3 x Stage Blinder 2-lite
2 x Martin Atomic 3000
4 x Robe Spot 250xt mk2
1 x Look Unique 2 Hazer

For questions about light contact: Bart Mesman

Tel: +31 (0)6 43 03 65 61

Mail: bmesman@hotmail.com

LIGHT PLOT

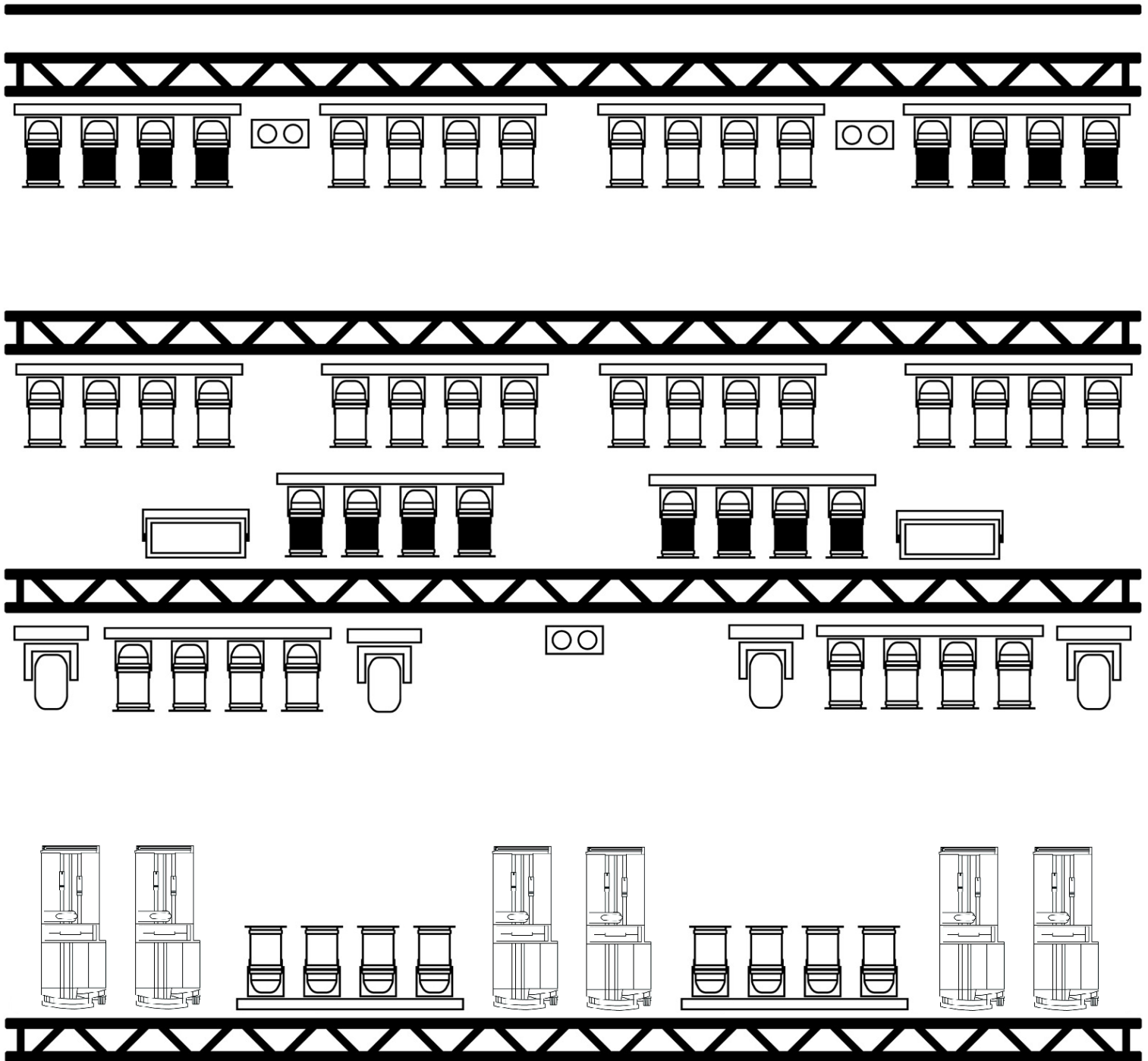

Legenda:

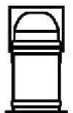

PAR 64
raylight

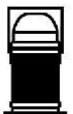

PAR 64
ACL

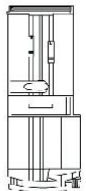

Profile spot
1,2 KW



Robe spot
250xt

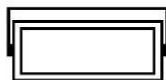

Martin Atomic
3000



Stage Blinder

CHANNEL LIST

DMX channel	Light	Position
1	Profile Spot	Front
2	Profile Spot	Front
3	Profile Spot	Front
4	Profile Spot	Front
5	Profile Spot	Front
6	Profile Spot	Front
7	4 bar PAR64	Front
8	4 bar PAR64	Front
9 - 12	4 bar PAR64	Back Truss
13 - 16	4 bar PAR64	Mid truss
17 - 20	4 bar PAR64	Mid truss
21-24	4 bar PAR64	Front truss
25	ACL	Back truss
26	ACL	Front truss
27	Fresnel spot	Side
28	Fresnel spot	Side
29	Floorspot	Stage
30	Floorspot	Stage
31	Floorspot	Stage
32	Floorspot	Stage
33	Atomic 3000 – dimmer	Left
34	Atomic 3000 – blind	Left
35	Atomic 3000 – shutter	Left
36	Atomic 3000 – fx	Left
37	Atomic 3000 - dimmer	Right
38	Atomic 3000 - blind	Right
39	Atomic 3000 - shutter	Right
40	Atomic 3000 - fx	Right
41	Blinder	Left
42	Blinder	Center
43	Blinder	Right
44	Hazer pump	Stage
45	Hazer fan	Stage
46 – 61	Robe spot 250xt	1
62 – 77	Robe spot 250xt	2
78 – 93	Robe spot 250xt	3
94 - 109	Robe spot 250xt	4